



CROSSBORDER
PMI ADVISORS

Your Gateway to the World



Our Experience Available on Demand
Crossborder Hotlines





Crossborder Hotlines: Content and basis of charges

Whether pre-Deal or Post Deal, crossborder M&A gives rise to many unfamiliar situations. Crossborder PMI Advisors understands the needs of clients to have quick access to deep crossborder experience to answer questions, get advice, or to confirm understandings. With this in mind Crossborder PMI Advisors offer its valued clients a retainer based subscription to a hotline service, enabling questions to be placed as they arise to our network of experts.

Areas of expertise covered by hotline

- M&A Execution Technical Questions
- Negotiation Strategy
- Day one issues
- Cultural advice
- PMI Approach
- People Retention
- Other (based on client request)



Basis of Charges

- Spot basis questions: Regular hourly charge billed in arrears
- Subscription based services:
 - Billed monthly in advance
 - Scaled based on usage
 - Basic: 20hrs/month
 - Standard: 20-50hrs/month
 - Premium: Unlimited
 - Also scaled based on breadth
 - Limited: one specific area of focus
 - Medium: up to 3 areas of focus
 - Comprehensive: Unlimited
 - Scaling adjustable monthly

For further information, quotation or subscription,
please contact us at: info@xbpmi.jp

How it works:

To begin you hotline membership, please contact us at info@xbpmi.jp to discuss your subscription level, obtain a quotation and complete registration for approved users. Following registration, you will be invoiced for the first monthly subscription, and your memberships will be activated upon receipt of payment. Your subscription level for subsequent months will be confirmed on the 25th of each month.

Alternatives for submission of questions:

- Email to: hotline@xbpmi.jp (please quote your membership number)
- XB PMI Hotline iPhone app (see right)
- Customized Blog
- Fixed periodic video or voice calls



Receipt of response

- Email to registered member (or all members of clients registered team)
- Customized Blog
- Fixed periodic video or voice calls
- Direct call or face to face meeting (premiums may apply for significant out of hours contact, or extended travel time)

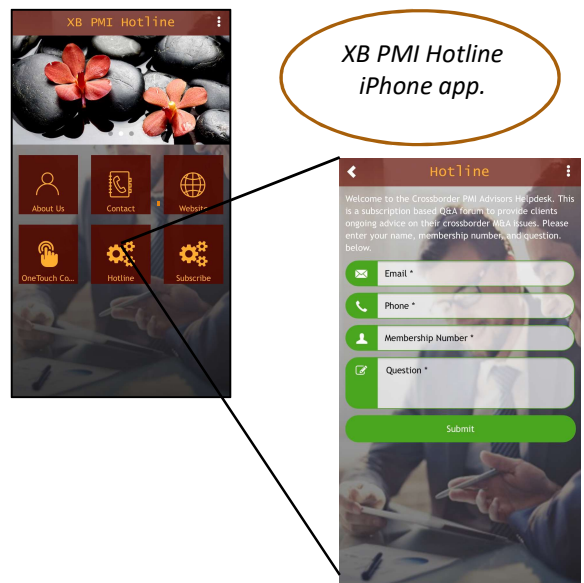

Our hotlines can be customized for our clients specific needs. Please contact us for further information



CROSSBORDER
PMI ADVISORS

Contact:

Crossborder PMI Advisors

Tokyo Sankei Bldg, 1-7-2 Otemachi, Chiyoda-ku, Tokyo, Japan 100-0004

Tel: +81-80-6626-9525

For further information or RFP, please mail to: info@xbpmi.jp

Follow Crossborder PMI Advisors on Social Media

Linkedin: <https://www.linkedin.com/company/crossborder-pmi-advisors/>

Twitter: https://twitter.com/hashtag/Crossborder_PMI_Advisors?src=hash/